



# Floor/Interior: under 1/2" Plywood and Hardwood

REFERENCE:

## PRODUCT ASSEMBLY

### 1. Hacker Top-Coat®SP

An acrylic-based, film forming surface preparation agent.

### 2. (a) FIRM-FILL® Gypsum Concrete

Has compressive strength up to 2000 psi (ASTM C472).

#### (b) FIRM-FILL® 2010

Has compressive strengths from 1950-2750 psi (ATM C472).

#### (c) FIRM-FILL® 3310

Has compressive strengths from 2000-3300 psi (ASTM C472).

### 3. (a) FIRM-FILL® SCM-125

A 1/8" dimensional Sound Control Mat

#### (b) Quiet Qurl® 55/025

A 1/4 inch (6mm) entangled mesh sound control mat

#### (c) HackerSound Mat II

A 1/4 inch (6mm) recycled rubber sound control mat.

### 4. Hacker Floor Primer

A rewettable latex primer that is diluted 4:1

#### Note

*Some installation methods and components are not referenced. Please consult all approved resources to ensure a complete assembly.*

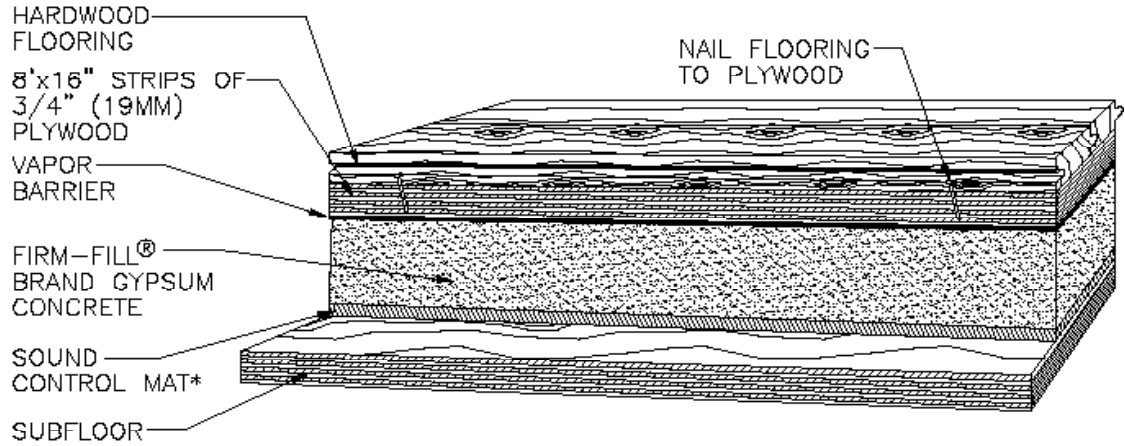

## When installing floating hardwood over FIRM-FILL® Brand Gypsum Concretes:

### General Recommendations:

Prepare the underlayment according to Page 1 of "Guidelines for Installing Finished Floor Coverings" and adhere to the floor goods manufacturer's general and installation recommendations. Insure Floating Floor goods are acclimated to environment as per manufacturer's recommendations prior to installation.

Make sure the underlayment is clean and has passed a dryness test. The recommended procedure to test dryness is to use a moisture meter with gypsum scale.

Hacker Industries" recommends three moisture meters:

- Delmhorst BD-2100
- Delmhorst G-79
- Tramex CRH

Results should be reported to the general contractor for use by all flooring installers. The floor goods manufacturer will determine acceptable levels of dryness (see ASTM F2419).

### Caution:

Calcium chloride/moisture dome testing is not reliable for gypsum concrete moisture testing.

**HACKER INDUSTRIES, INC.**  
1600 Newport Center Drive  
Newport Beach, CA 92660

**PHONE**  
(949) 729-3101

**WEB**  
www.hackerindustries.com  
info@hackerindustries.com